

3201 Double Hung Window

Features:

- Sashes tilt in for easy cleaning
- Integrated nail fin available
- Available accessory groove improves exterior aesthetics
- Positive-action cam lock enhances safety
(2 locks standard at 27 1/4" or wider)
- Insulated glass panels with optimum thermal air space featuring a warm-edge spacer system
- Half screen comes standard
- Sloped sill reduces air infiltration and accommodates easy water run-off
- Fusion-welded sashes and frame add strength and additional insulation
- Constant force coil balance permits easy sash movement
- Dual push-button night latches provide easy, secure ventilation
- Jamb depth: 3.25"
- Transferable limited lifetime warranty

Custom Options:

- Low-E Glass
- Low-E Glass with Argon Gas
- Ultra Low-E Glass with Argon Gas
- Obscure glass
- Double strength glass
- Optional 5/8" or 1" contoured grid, 5/8" or 3/4" flat grid, and 5/8" contoured valance available
- Aluminum charcoal mesh screen
- Window Opening Control Device
(for fall prevention)
- Nine exterior painted colors (white interior only)
- InsulKor™ Multi-Cavity Foam-Filled Frame
- Lifetime glass breakage warranty

Product Performance:

AAMA 101 Results:

Window Size	AAMA Rating (psf)	Air (cfm/ft ²)	Water (psf)
48" x 78" (X/X)	LC-PG25	0.10	5.43
36" x 74" (X/X)	LC-PG35	0.10	5.43
109" x 74" (X/X – X/X – X/X DH Muller Triple)	DP35	0.13	5.43

Product Dimensions:

Vinyl Wall Thickness:	0.062"
Typ. Glass Thickness:	0.750"
Jamb Depth:	3.250"
Mullion Adder:	
Standard:	0.125"
High Performance:	0.2500" XX
	0.3750" XO
	0.6250" OO

Rough Opening:

Window Width + 1/4"
Window Height + 1/4"

Size Restrictions:

	Min:	Max:
Width	14 1/2"	54"
Height	23 1/8"	91"

(Max. United Inches 126")



3201 Double Hung Window

Egress Formulas:

Egress Width $\geq 20"$ and Egress Height $\geq 24"$ and Egress Area $\geq 5.7 \text{ ft}^2$ required to meet egress.

Egress Width Formula = Window Width – 5"

Egress Height Formula = (Window Height/2) – 6.250" (1 Coil)

(Window Height/2) – 7.875" (2 Coils)

(Window Height/2) – 9.500" (3 Coils)

Egress Area Formula = (Egress Width x Egress Height)/144

Screen Formulas:

Window Width – 4.500" (Full Screen)

Window Height – 3.250" (Full Screen)

Window Width – 4.4375" (1/2 Screen)

(Window Height/2) – 0.500" (1/2 Screen)

Nail Fin Setback: 1.375"

Frame Setback: 1.75"

Nail Fin Length: 1.375"

Mull Add on: No Add on

Cross Sections:

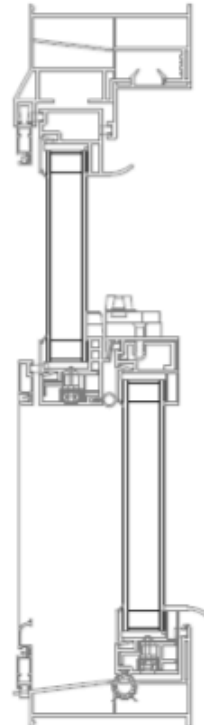
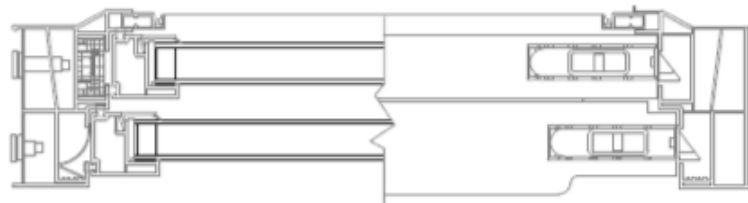

Standard Mullion Assembly:

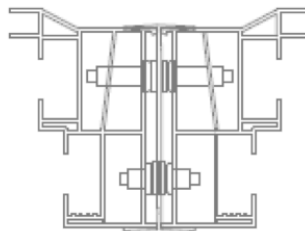

High Performance Mullion Assembly:

